

# Rustic HAT RACK

## CREATIONS WOODSHOPCLASS

[WWW.YOUNGFOUNDATIONS.ORG/CREATIONS](http://WWW.YOUNGFOUNDATIONS.ORG/CREATIONS)



### WHAT'S IN YOUR PACKET?

Lesson for teacher use.....page 2  
Project Tutorial.....pages 3-7



# CLASS NAME: Rustic HAT RACK

**Start class with a word of prayer.**

## SCRIPTURE

And they rose early in the morning, and went forth into the wilderness of Tekoa: and as they went forth, Jehoshaphat stood and said, Hear me, O Judah, and ye inhabitants of Jerusalem; Believe in the LORD your God, so shall ye be established; believe his prophets, so shall ye prosper.

II CHRONICLES 20:20

## QUOTE

**“May I stop here a minute? You Presbyterians, Methodists, and Baptists, or you Pentecostals, fifty years ago we’d have got the promised Land, but you got to fussing among one another, making organizations out from one side, and this one getting this, and this one and getting this, and a new revelation, instead of following the Word. And now we been fifty years this side the full Promise.**

**But, remember, it was forty years, but Joshua wants you all to know that God kept His Word, with a brand new generation. He took the promised land just as it was promised, ‘cause he stilled the people on the Word of God, to let them know that God made the promise, that this prophet they were following was not a false prophet, because the things that he was doing was exactly with the Scripture. No matter how falsely Pharaoh said it was, how falsely magicians try to say it was, how that they could do the same thing, and everybody do the same thing.”**

**Rev. William Marrion Branham  
64-0427 A Trial**

QUOTE MINUTE MARKER: **54:35 - 55:37, PARAGRAPH 146 - 147**



# Rustic HAT RACK tutorial

## MATERIALS NEEDED:

assorted wood  
wood glue  
acetone  
rag or sponge  
gloves  
finish (ex: mineral oil)  
screws

## TOOLS NEEDED:

safety glasses  
measuring tape  
pencil  
clamps  
sand paper  
band saw  
miter saw  
drill  
drill bit (slightly thicker than your pegs)  
hammer  
box cutter or knife  
pin nailer

## CUT LIST:

**Base:** 1 piece 7" wide x 25" long x 7/8" thick

**Pegs:** 4 round pieces of desired length and thickness

**Wedges:** 4 pieces as wide as pegs and 1 1/2" long  
(one end thicker than the other)

**Rack mounting pieces:** 2 pieces 1 5/8" wide x 12" long x 11/16" thick

**Wall mounting piece:** 1 piece 4 1/2" wide x 7 1/2" long x 3/4" thick

\*Parental assistance recommended.



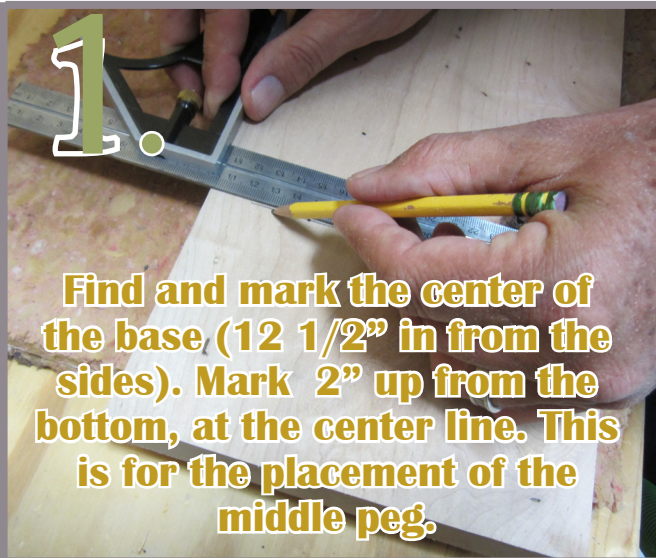

**1.**  
Find and mark the center of the base (12 1/2" in from the sides). Mark 2" up from the bottom, at the center line. This is for the placement of the middle peg.

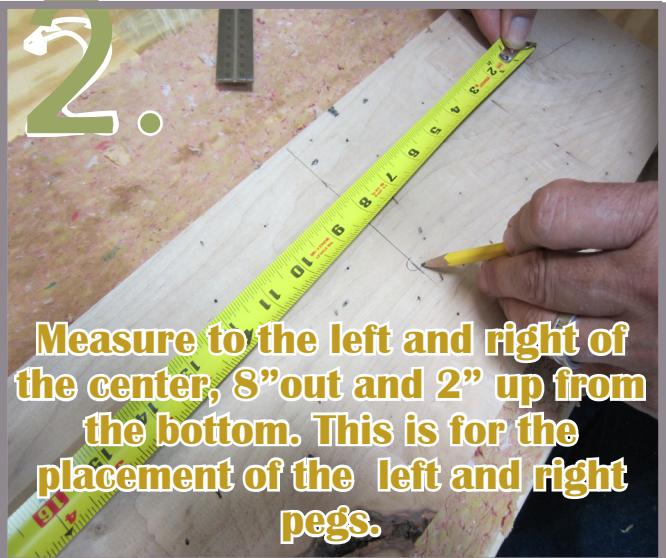

**2.**  
Measure to the left and right of the center, 8" out and 2" up from the bottom. This is for the placement of the left and right pegs.

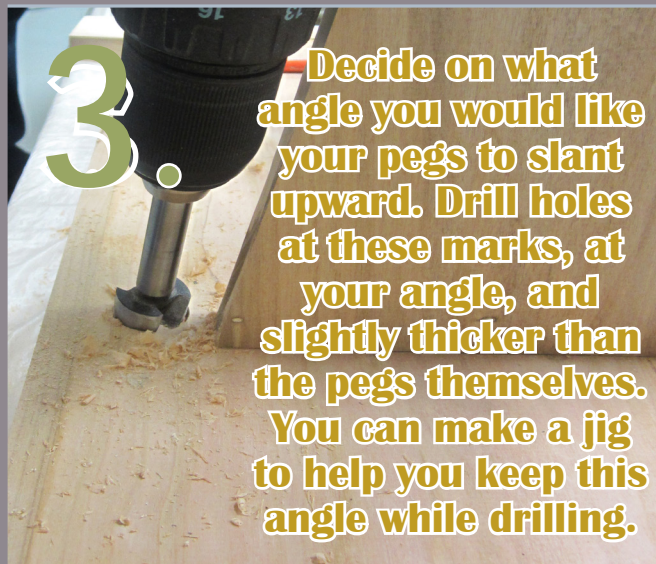

**3.**  
Decide on what angle you would like your pegs to slant upward. Drill holes at these marks, at your angle, and slightly thicker than the pegs themselves. You can make a jig to help you keep this angle while drilling.



**4.**  
Cut a 1 1/2" deep slit on one end of each peg.



**5.**  
Slide a wedge into each slit. Do not hammer completely in.



**6.**  
Use a box cutter or knife to shave off the slitted end of the pegs.

7.

Coat the slitted end of the pegs and insert into the holes with wedges perpendicular to the base. Use a block of wood between the hammer and the pegs to protect the pegs. Make sure the peg sticks out the other end.



8.

Hammer the wedges in until snug from the back-side. Make sure the peg stays in place.



9.

Clean up any glue on the front and back. Cut off the back of the peg and wedge, to make it flush with the base.



10.

Rip a 45 degree angle on one long side of the top and bottom rack mounting pieces.

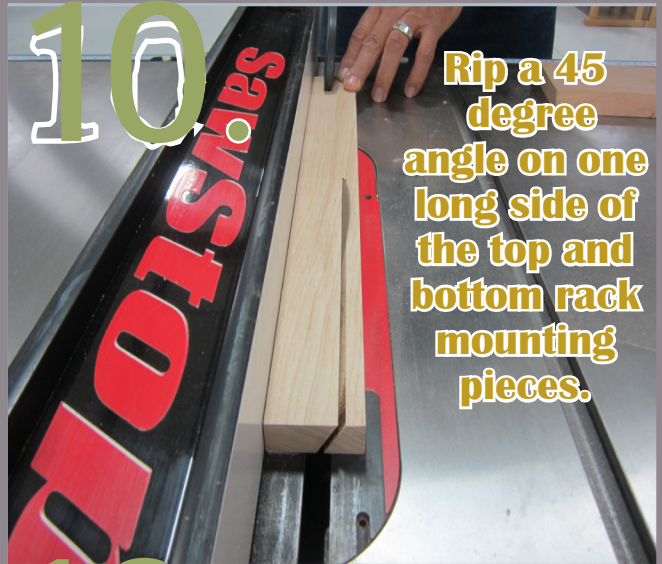

Rip a 45 degree angle on both long sides of the wall mounting pieces.

11.

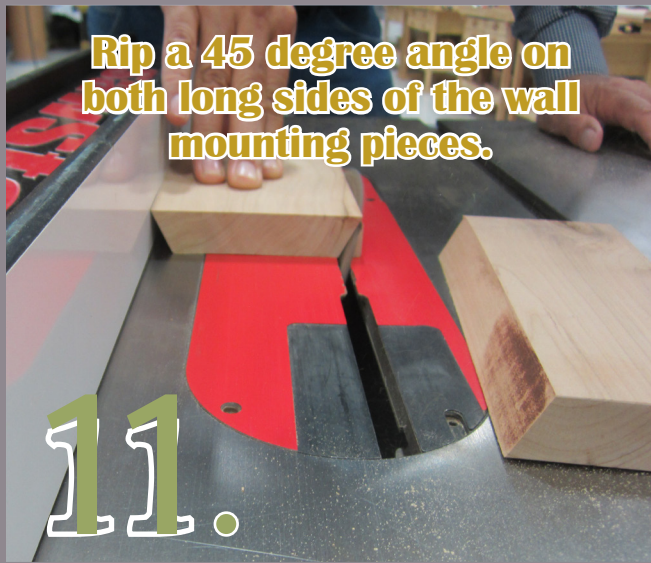

12.

Glue and pin nail one rack mounting piece to the top back of the base. Make sure the flat long side is flush with the top edge of the base so that the 45 degree angle side is facing down.

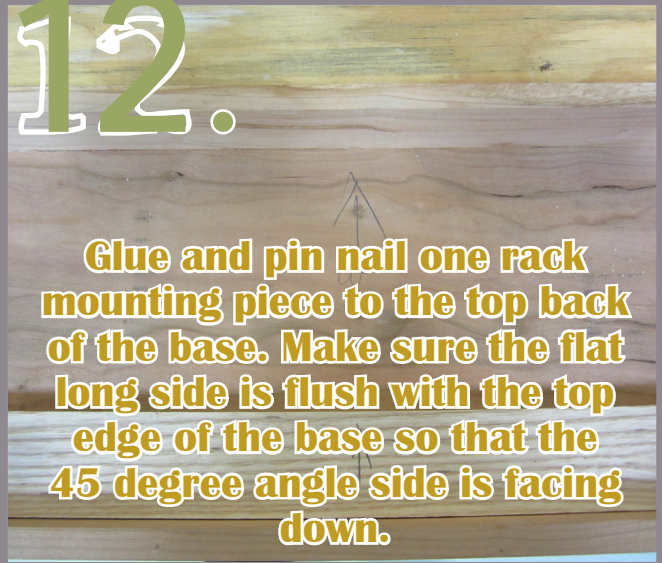

13.

Slide the wall mounting piece next to the top rack mounting piece so there is a snug fit. Do not glue this piece in.

14.

Slide the other rack mounting piece next to the wall mounting piece so that the angles fit snug against each other. Place a few pieces of paper between the gap to get the correct spacing.

15.

Glue and pin nail the bottom mounting piece to the rack base.

16.

Slide out the wall mounting piece and wait for the glue to dry.

Sand down the entire project.

17.

**OPTIONAL:**

1.

Choose a design to apply to the front of your rack. You can use the options in this tutorial or create your own. \*\*The design must be flipped horizontally 180 degrees when printed and on a laser printer.



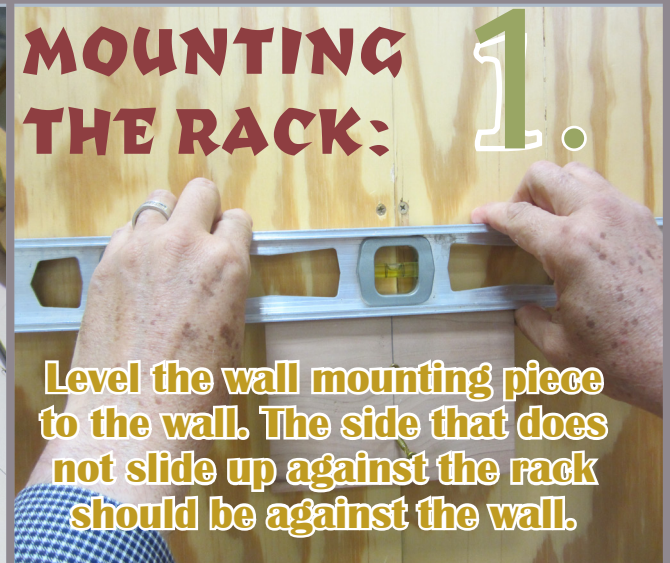
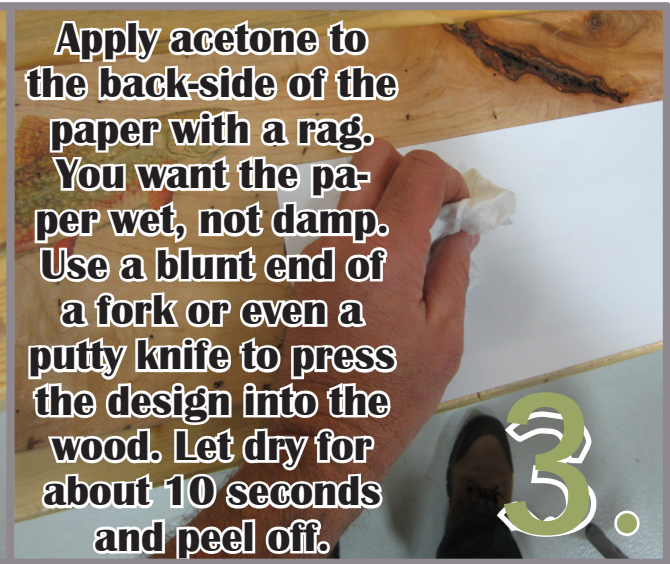
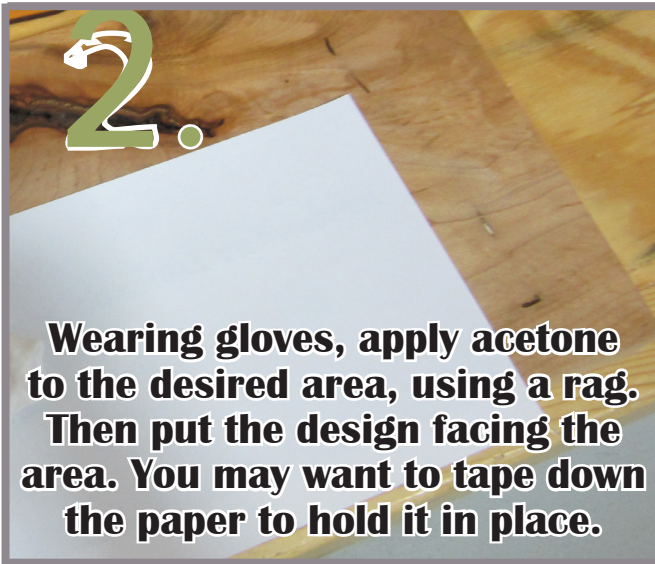

**You're finished!**

